

Part No. **BP37R2313S100B**

1. Electrical Specifications.

ITEM		Specifications
Center Frequency (= Fc)		2313.5 MHz
Pass Band-width (=BW)		Fc +/- 50 MHz
I.L in BW		4.5 dB max.
Ripple	BW	1.5 dB max.
	Fc +/- 12.5 MHz	0.5 dB max.
Return Loss @ BW		12 dB min..
Attenuation		60 dB min. @ 2193.5 MHz
In/Out Impedance		50 Ω
Input Power		1 W max.
Operation Temperature		-30°C ~ +85°C

2. Dimensions.

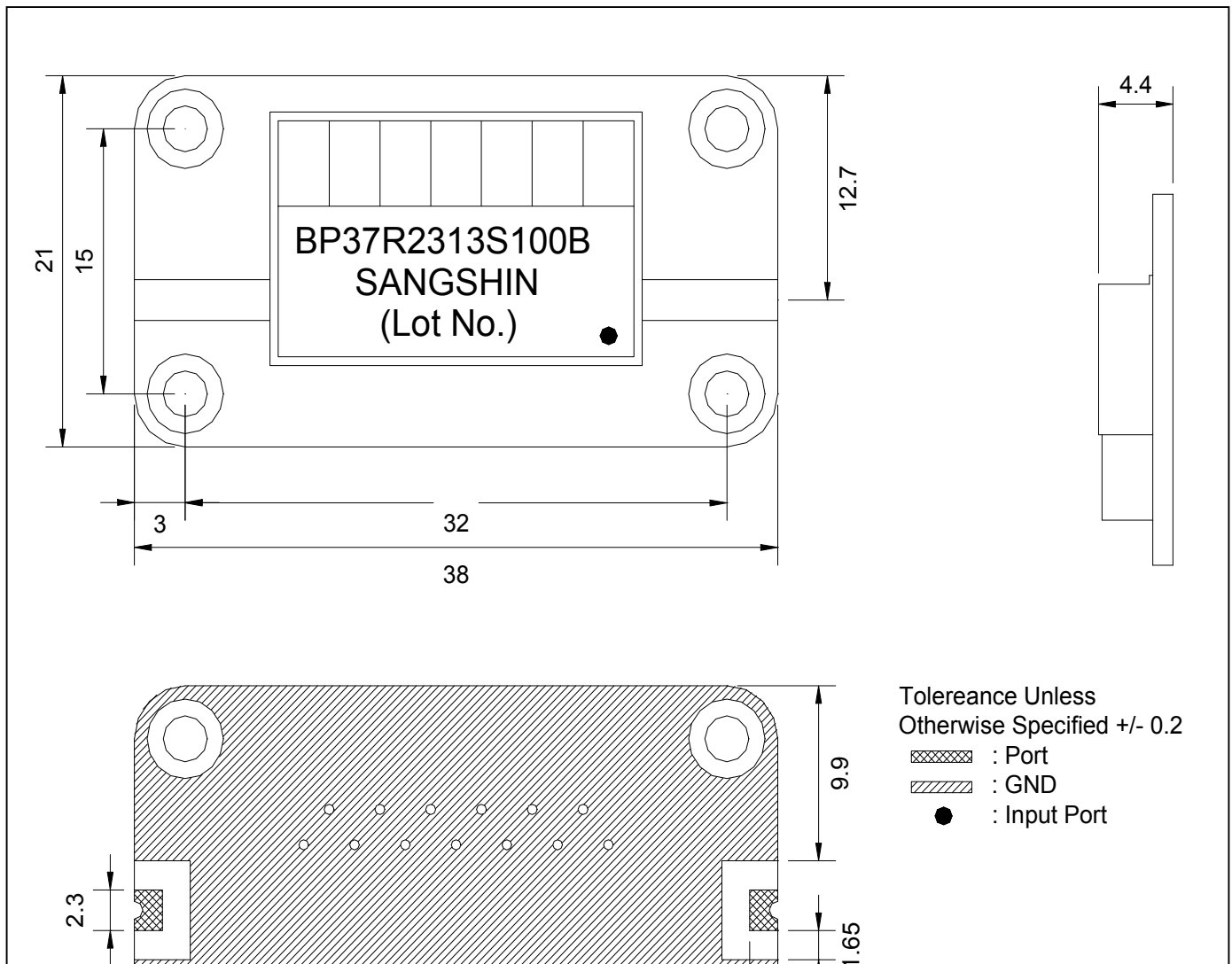

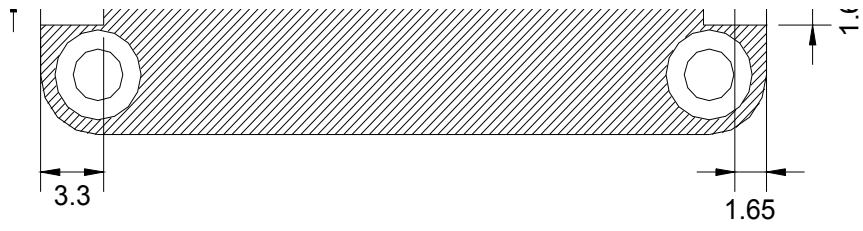

3. Data

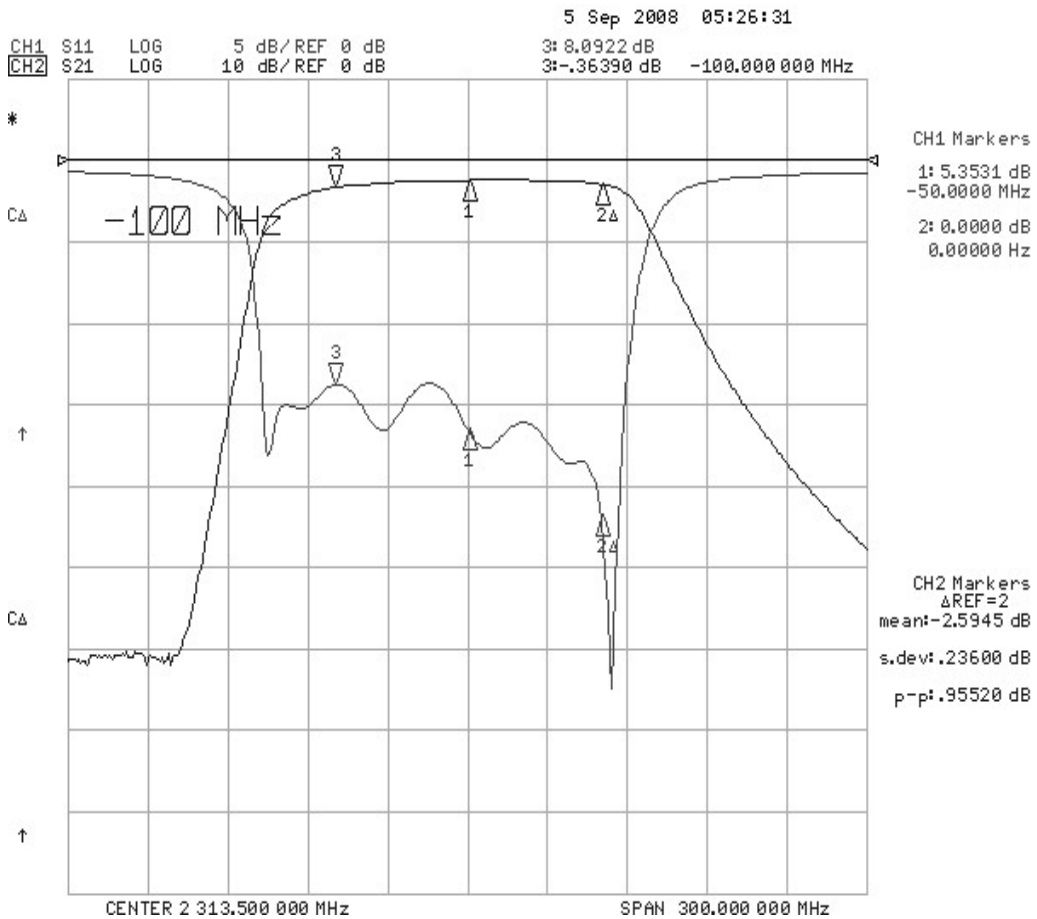
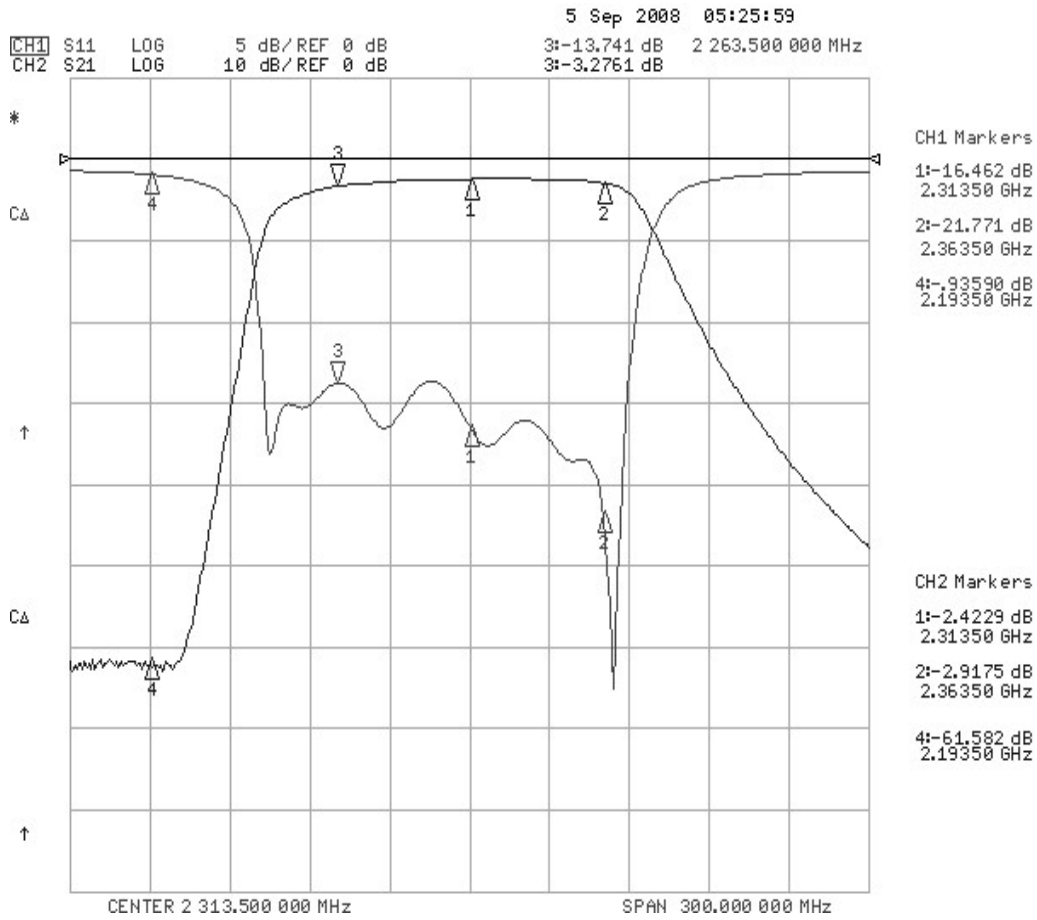

5 Sep 2008 05:27:07

CH1 S11 LOG 5 dB/REF 0 dB 5: 3.1985 dB
CH2 S21 LOG 10 dB/REF 0 dB 5: -1.5090 dB -25.000 000 MHz

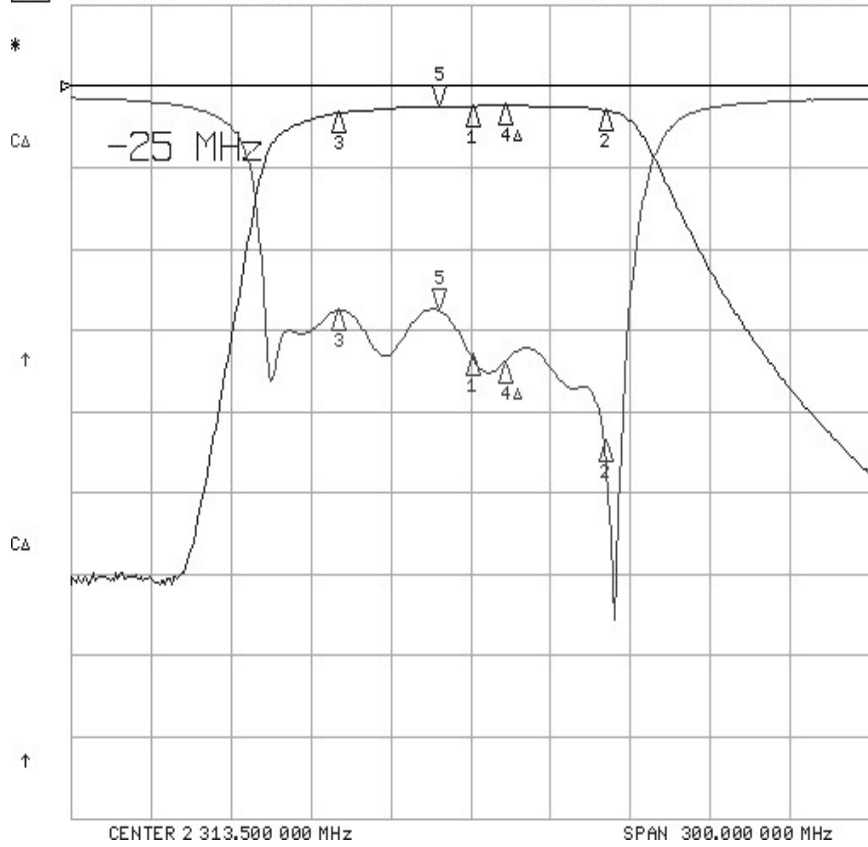

CH1 Markers

1: 4.6140 dB
-12.5000 MHz
2: -4.8717 dB
37.5000 MHz
3: 3.2042 dB
-62.5000 MHz
4: 0.0000 dB
0.00000 Hz

CH2 Markers
ΔREF=4
mean: -2.4288 dB
s.dev: .05370 dB
p-p: .15190 dB

